

Inside heights

19
-
87

Inside widths

24
-
800

kabelschlepp.de

Fon:

+49 2762 4003-0

OnlineEngineer.de
TSUBAKI KABELSCHLEPP
Cable Carrier Configurator

M Series

Multivariable cable carrier
with extensive accessories and stay variants*

■ TÜV design approved in accordance
with 2PfG 1036/10.97**

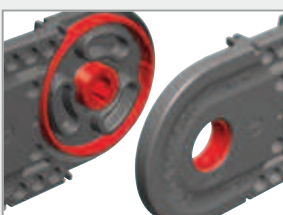
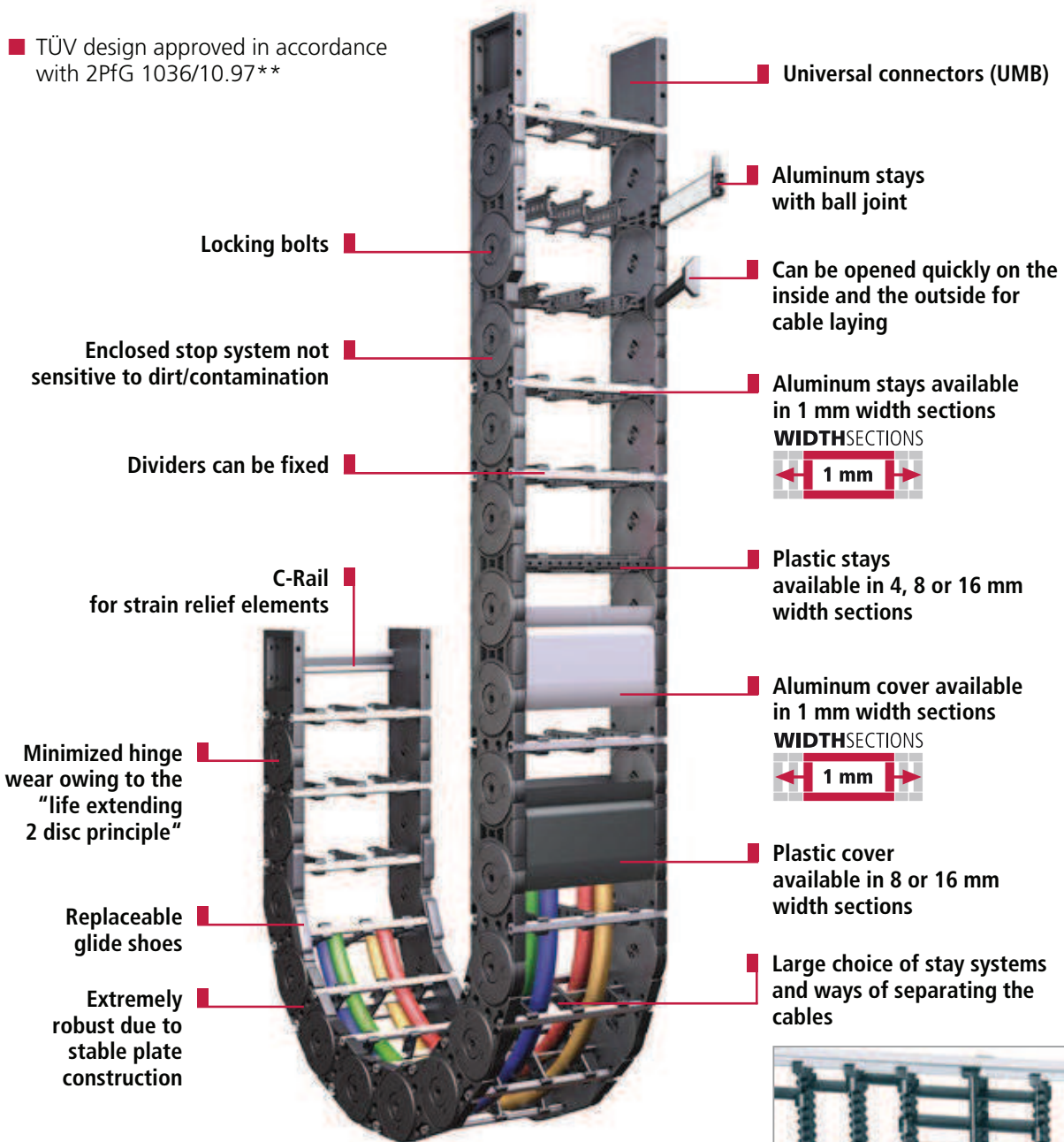

Minimized hinge wear owing to the "life extending 2 disc principle"



Solid plate construction, enclosed impact system



Easy to assemble thanks to locking bolt with Allen screw



Replaceable glide shoes for long service life for gliding applications

Overview M Series

Type MC with detachable aluminum stays

WIDTHSECTIONS



- Available in 1 mm width sections

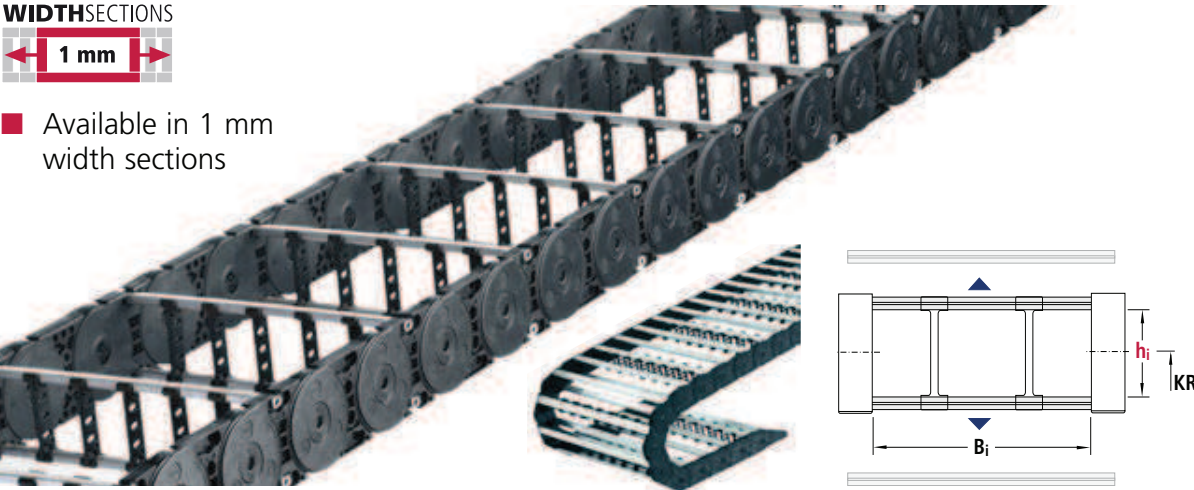

Type	h _i	B _i	Maximum travel length in m	Dynamics of unsupported arrangement		Page
				Travel speed v _{max} in m/s	Travel acceleration a _{max} in m/s ²	
MC 0320	19	25-280	80	10	50	185
MC 0650	38	75-500	220	8	40	185
MC 0950	58	100-600	260	6	30	185
MC 1250	72	100-800	320	5	25	185
MC 1300	87	100-800	350	5	25	185

Dimensions in mm

Type ME with unscrewable plastic stays

- Available in 4, 8, 16 mm width sections

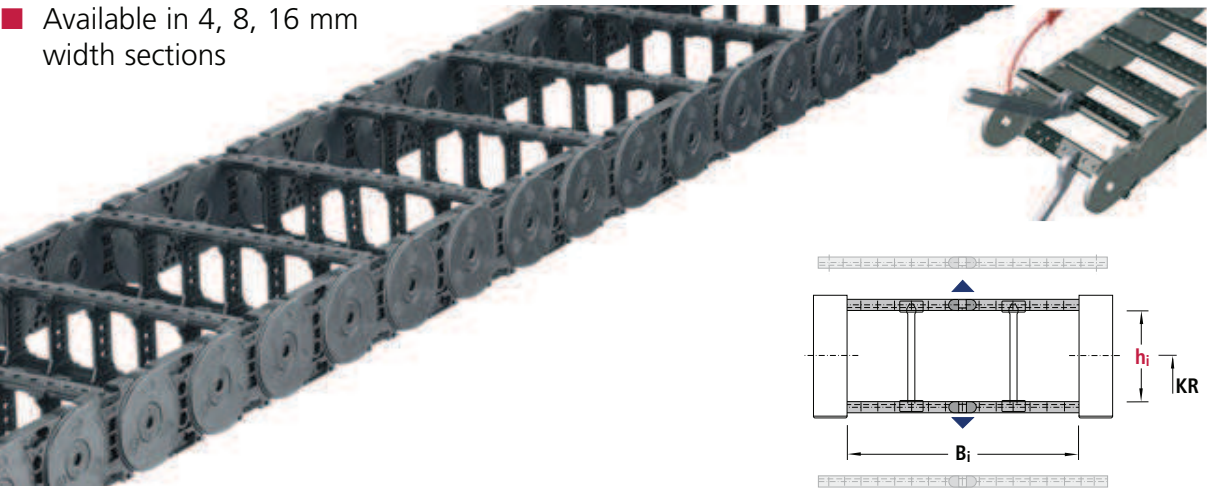

Type	h _i	B _i	Maximum travel length in m	Dynamics of unsupported arrangement		Page
				Travel speed v _{max} in m/s	Travel acceleration a _{max} in m/s ²	
ME 0320	19	25-149	80	10	50	192
ME 0650	42	50-266	220	8	40	192
ME 0950	58	45-557	260	6	30	192
ME 1250	72	71-551	320	5	25	192

Dimensions in mm

Subject to change.

Overview M Series

Type MK with openable plastic stays

- Available in 8 or 16 mm width sections

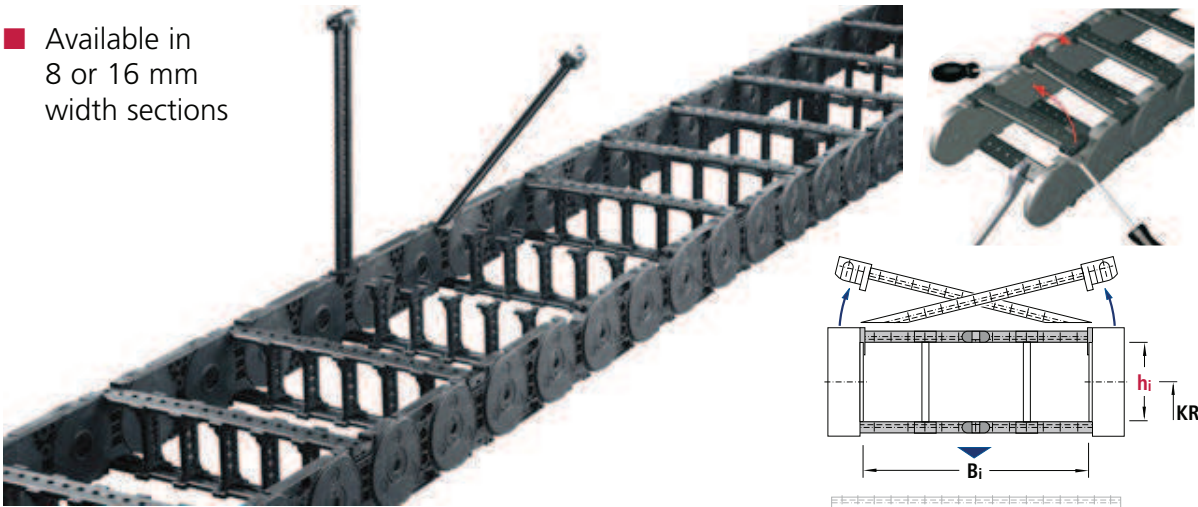

Inside heights

19
—
87

Inside widths

24
—
800

kabelschlepp.de

Type	hi	Bi	Maximum travel length in m	Dynamics of unsupported arrangement		Page
				Travel speed v_{max} in m/s	Travel acceleration a_{max} in m/s ²	
MK 0475	28	24-280	120	10	50	192
MK 0650	42	50-258	220	8	40	192
MK 0950	58	45-557	260	6	30	192
MK 1250	72	71-551	320	5	25	192

Dimensions in mm

TUBE SERIES – covered cable carriers

Type MT with plastic or aluminum cover system

- Available types: MT 0475, 0650, 0950, 1250 and 1300

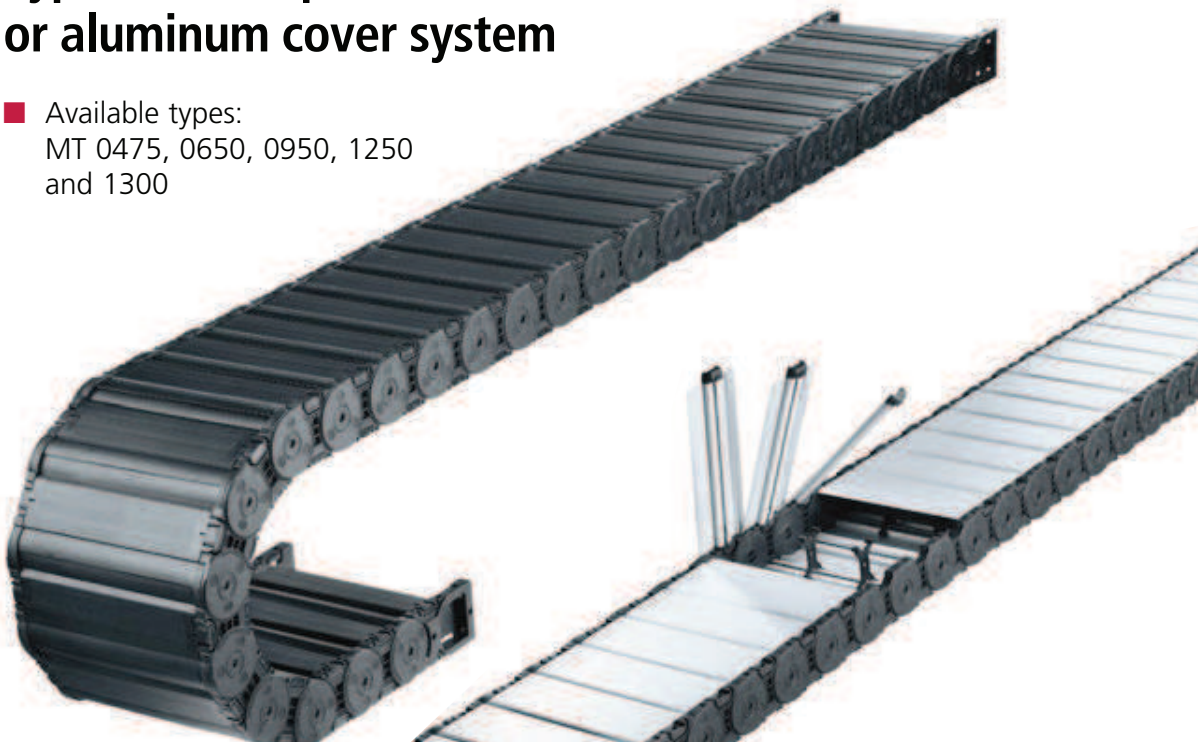

Fon:

+49 2762 4003-0

OnlineEngineer.de
TSUBAKI KABELSCHLEPP
Cable Carrier Configurator

Inside
heights19
–
87Inside
widths25
–
800

kabelschlepp.de

Fon:

+49 2762 4003-0

Use our free
project planning service.

Type MC

with aluminum stays

■ Available in 1 mm width sections

WIDTH SECTIONS
1 mm



Stay variants

Frame stay RS

Standard design –
MC 0650 and 0950

For lightweight to medium loads.

Opening options:

Outside/Inside: the cable carrier can be opened quickly and easily simply by rotating the stays through 90°.



Frame stay RV

Reinforced design –
MC 0950 and 1250

For medium to heavy loads and for large chain widths.

Opening options:

Outside/Inside: the cable carrier can be opened quickly and easily simply by rotating the stays through 90°.



Frame stay RM

Solid design –
MC 0950 and 1250

Bolted, maximum stability,
maximum chain widths possible.



Frame stay RMF

Solid design
with optional fixing strip –
Standard for MC 1300

Opening options:

Outside/Inside: Stays easily screwed on. Stays can be removed quickly on both sides for laying cables.

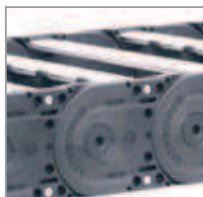

Frame stay RMS

Solid design
with ball joint – MC 1300

Opening options:

Outside/Inside: Stays with ball joint can be opened quickly and easily on both sides.

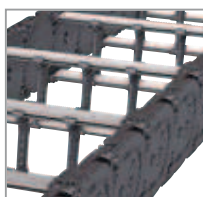

Stay arrangement

MC 0320 – Stays mounted on every chain link.

MC 0650, 0950, 1250 and 1300 –

Standard: on every 2nd chain link

Stays can be fitted on every chain link, please specify when placing your order.

Opening options MC 0320

Opening option 02: Detachable stays on the outside (standard)

Opening option 01: Detachable stays on the inside.

If you require opening variant 01, please state this when placing your order.

Additional stay variants:



Stay variant LG made of aluminum: Optimum cable guidance in the neutral bending line



Stay variant RMA: For very large cable diameters, such as e.g. with air hoses



Stay variant RMR: Gentle cable laying by means of rollers. Ideal when using hydraulic hoses with "soft" sheaths

Types MC 0320, 0650, 0950, 1250, 1300

Dimensions and intrinsic chain weight

Type	Stay variant	h_i	h_G	B_i min	q_k min	B_i max	q_k max	B_k
MC 0320	RS	19	27.5	25	0.42	280	1.65	$B_i + 11$
MC 0650	RS	38	57	75	2.00	400	3.80	$B_i + 34$
MC 0950	RS	58	80	100	3.20	400	4.70	$B_i + 39$
MC 0950	RV	58	80	100	3.50	500	5.90	$B_i + 39$
MC 0950	RM	54	80	100	3.40	600	6.60	$B_i + 39$
MC 1250	RV	72	96	100	4.40	600	6.30	$B_i + 45$
MC 1250	RM	69	96	100	4.50	800	8.40	$B_i + 45$
MC 1300	RMF	87	120	100	6.10	800	9.20	$B_i + 50$
MC 1300	RMS	87	120	100	6.10	800	9.20	$B_i + 50$

Dimensions in mm/Weights in kg/m

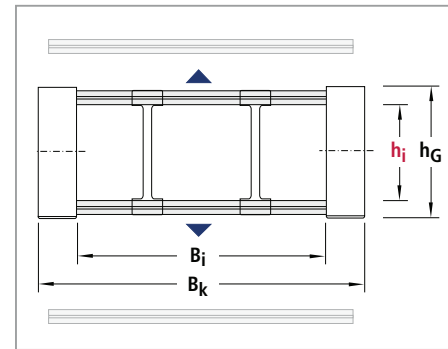

Inside heights

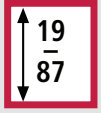

Inside widths



Dimensions and intrinsic chain weight

Type	Bend radii KR mm									
MC 0320	37	47	77	100	200	—	—	—	—	—
MC 0650	75	95	115	145	175	220	260	275	300	350
MC 0950	140	170	200	260	290	320	380	—	—	—
MC 1250	180	220	260	300	340	380	500	—	—	—
MC 1300	150	195	240	280	320	360	400	500	—	—

Pitch:

MC 0320: $t = 32$ mm

MC 0650: $t = 65$ mm

MC 0950: $t = 95$ mm

MC 1250: $t = 125$ mm

MC 1300: $t = 130$ mm

Load diagram

for unsupported length L_f depending on the additional load

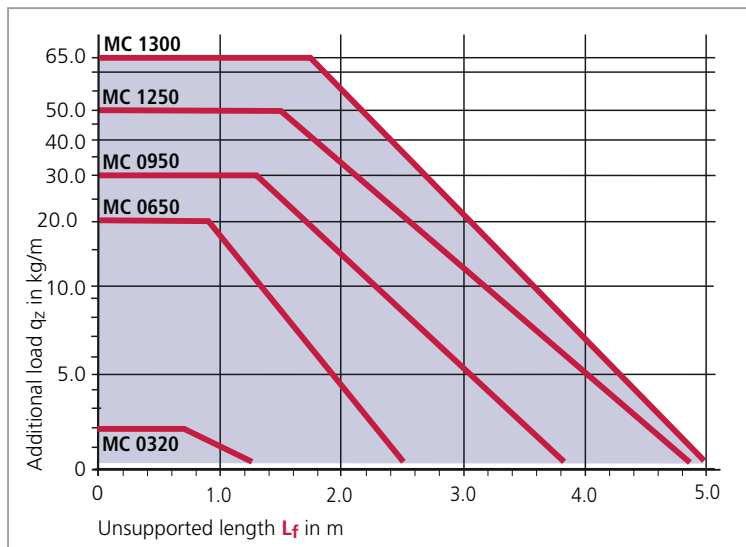

Unsupported length L_f

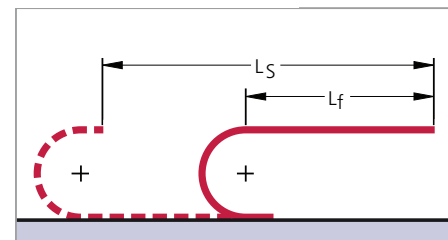

In the case of longer travel lengths, sag of the cable carriers is technically permissible depending on the application.

In a gliding arrangement, even longer travel lengths are possible (see page 375).

We are at your service to advise on these applications.

Example of ordering

Cable carrier					Divider system		Connection
MC 1300	600	RMF	360	2600	TS 0	7	FU/MU
Type	Inside width B_i in mm	Stay variant	Bend radius KR in mm	Chain length L_k in mm (without connection)	Divider system	Number of dividers n_T	Connection Fixed point/Driver

Ordering divider systems:

Please state the designation of the divider system (TS 0, TS 1 ...) and the number of dividers. Possibly attach a sketch with the dimensions.

kabelschlepp.de

Fon: +49 2762 4003-0

OnlineEngineer.de
TSUBAKI KABELSCHLEPP
Cable Carrier Configurator

Types MC 0320, 0650, 0950, 1250, 1300

Divider system TS 0

Inside
heights

Inside
widths

Type	Stay variant	h_i mm	S_T mm	a_T min mm	a_x min mm
MC 0320	RS	19	2	3	6
MC 0650	RS	38	3	4.5	13
MC 0950	RS	58	4	4.5	14
MC 0950	RV	58	4	4.5	14
MC 0950	RM	54	4	7	14
MC 1250	RV	72	6	8	16
MC 1250	RM	69	5	10	20
MC 1300	RMF	87	5	7.5	15
MC 1300	RMS	87	5	15.5	15

The dividers can be moved in the cross section. Dimensions in mm
Fixed installation version for MC 1300 – see page 187

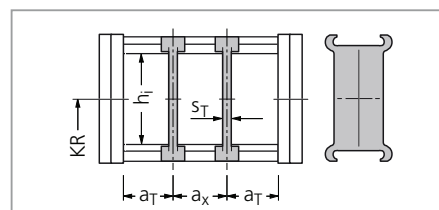

In the standard version, the divider systems are mounted on every second chain link.

Divider system TS 1 with continuous height subdivision made of aluminum

Type	Stay variant	h_i mm	S_T mm	a_T min mm	a_x min mm	S_H mm	h_1 mm	h_2 mm	h_3 mm
MC 0320	RS	19	2	3	6	2	10	–	–
MC 0650	RS	38	3	4.5	13	4	15	–	–
MC 0950	RS	58	4	4.5	14	4	30	–	–
MC 0950	RV	58	4	4.5	14	4	15	30	–
MC 1250	RV	72	6	8	16	4	15	30	45
MC 1300	RMF	87	5	7.5	15	4	24	48	–
MC 1300	RMS	87	5	15.5	15	4	24	48	–

The dividers can be moved in the cross section. Dimensions in mm
Fixed installation version for MC 1300 – see page 187

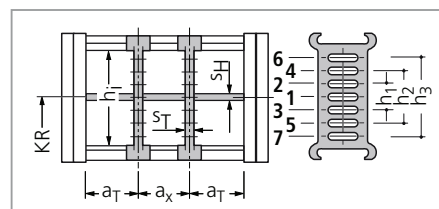

In the standard version, the divider systems are mounted on every second chain link.

Divider system TS 2 with grid subdivision made of aluminum (1 mm grid)

Type	Stay variant	h_i mm	S_T mm	a_T min mm	a_x min mm	S_H mm	h_1 mm	h_2 mm	h_3 mm
MC 0950	RM	54	6	7	16	4	15	30	–
MC 1250	RM	69	6	7	16	4	15	30	45

The dividers can be moved in the cross section. the complete divider system is movable.

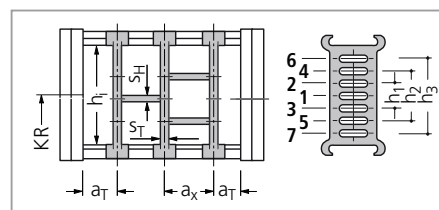

In the standard version, the divider systems are mounted on every second chain link.

Divider system TS 3

MC 0650, 0950, 1250 and 1300 with section subdivision, partitions made of plastic.

For these types, divider system TS 2 with grid subdivision made of aluminum (1 mm grid) is also available.

Type	Stay variant	h_i mm	S_T mm	a_T min mm	a_x min mm	S_H mm	h_1 mm	h_2 mm	h_3 mm	h_4 mm
MC 0650	RS	38	8	4	16*	4	14	28	–	–
MC 0950	RV	58	8	4	16*	4	14	28	42	–
MC 1250	RV	72	8	4	16*	4	14	28	42	56
MC 1300	RMF	87	8	7.5	16*	4	14	28	42	56
MC 1300	RMS	87	8	15.5	16*	4	14	28	42	56

The dividers are fixed by the partitions, the complete divider system is movable.
Fixed installation version for MC 1300 – see page 187

Dimensions in mm
* When using plastic partitions

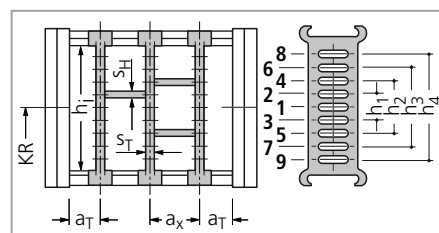

In the standard version, the divider systems are mounted on every second chain link.

Types MC 0320, 0650, 0950, 1250, 1300

Dimensions of the plastic partitions for TS 3

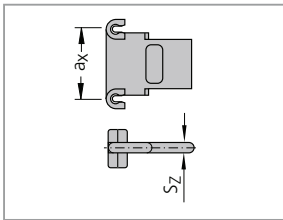

Aluminum partitions in 1 mm width sections are also available.

Sz	ax (center-to-center dividers)									
4	16	18	23	28	32	33	38	43	48	58
	64	68	78	80	88	96	112	128	144	160
	176	192	208	—	—	—	—	—	—	—

Dimensions in mm

When using partitions with $a_x > 112$ mm there should be an additional central support with a **twin divider**.

Thickness of the twin dividers: MC 0650 $S_T = 3$ mm, MC 0950, 1250, 1300 $S_T = 4$ mm

Twin dividers are designed for subsequent fitting in the partition system.

Inside heights

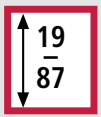

Inside widths

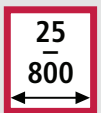

Fixing the dividers in 5 mm steps – Type MC 1300

In the standard version, dividers or the complete divider system (dividers with height separation) can be moved in the cross section.

Fixing profiles can be used to fix the dividers or complete divider systems.

Also best suited for applications where the carrier is rotated through 90° with extreme transverse accelerations (fixable dividers for stay variant RMF/RMS).

If the fixed installation version is required, please state this when placing your order.

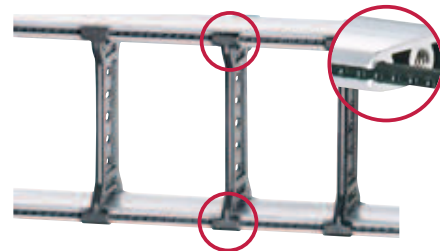

■ Secure seating of the dividers due to fixing on both sides.

■ The fixing profiles are simply pushed into the stays (RMF).

Gliding elements – the economical solution for gliding applications

Replaceable glide shoes made of plastic*

To extend the life of cable carriers in gliding operations KABELSCHLEPP supplies detachable, exchangeable glide shoes.

Replaceable glide shoes are a very economical solution. When wear occurs only the glide shoes are replaced, and not the complete cable carrier. For travel speeds > 2.5 m/s and large additional loads, a highly wear-resistant special material is used.

For types MC 0950 and 1250 **OFFROAD glide shoes** with 80 % greater wear volumes are also available. We recommend their use in extreme environmental conditions (with particularly abrasive materials such as e.g. sand, dust, corundum).

* Not for MC 0320



Chain height with glide shoes:

MC 0650:	$h_G' = h_G + 3.2 =$	60.2
MC 0950:	$h_G' = h_G + 3.5 =$	83.5
MC 1250:	$h_G' = h_G + 3.5 =$	99.5
MC 1300:	$h_G' = h_G + 7.0 =$	127.0

Dimensions in mm

Minimum bend radii when using glide shoes:

MC 0650:	$KR_{min} =$	95 mm
MC 0950:	$KR_{min} =$	140 mm
MC 1250:	$KR_{min} =$	180 mm
MC 1300:	$KR_{min} =$	195 mm

! By means of a positive snap connection, the glide shoes sit firmly on the chain link.

Minimized hinge wear owing to the "life extending 2 disc principle"

In the M Series*, the push and pull forces are transmitted via the optimum link design for this purpose.

As a result link wear is reduced to a minimum and the life of the cable carrier is considerably lengthened.

* not for type 0320

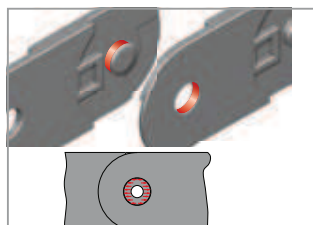

■ Force transmission with a pin-hole joint

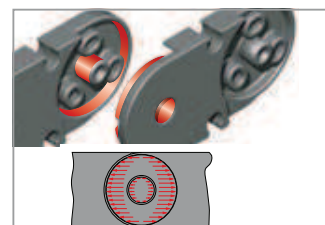

■ Force transmission with the "life extending 2 disc principle"

Inside
heights19
87Inside
widths25
800

kabelschlepp.de

Fon:

+49 2762 4003-0

Use our free
project planning service.

Types MC 0320, 0650, 0950, 1250, 1300

Connectors made of plastic/aluminum – Type MC 0320

Standard connectors without strain relief.

Connectors with strain relief available on request.

Fixed point connection

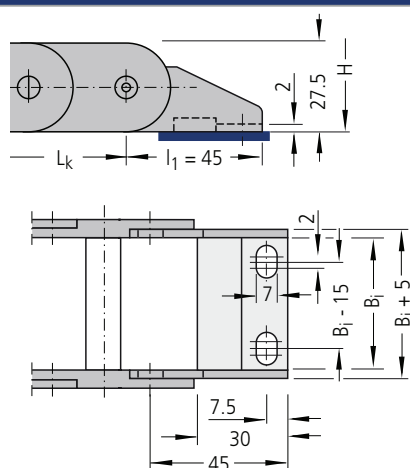

Driver connection

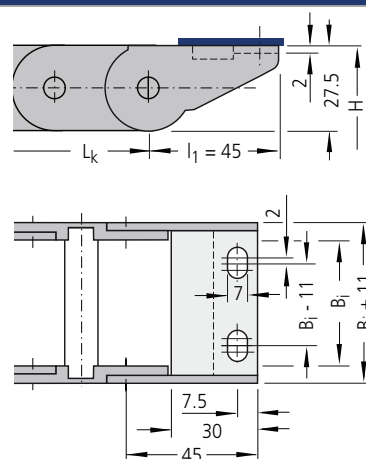

Connection variants – Type MC 0320

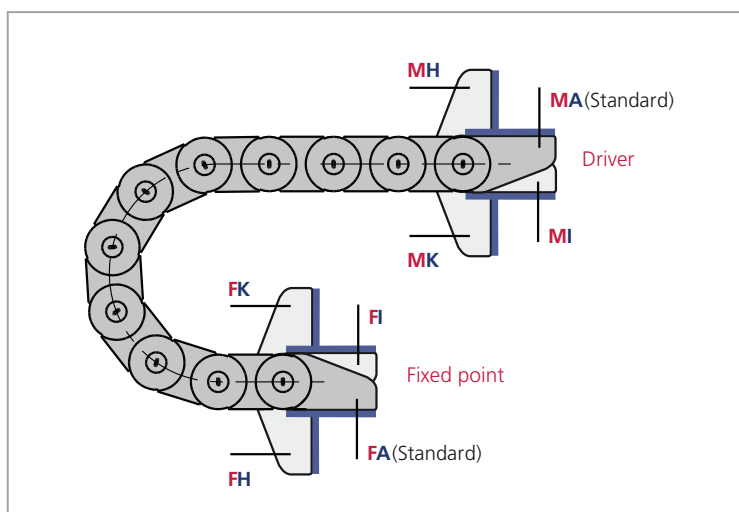

Connection point

M – Driver

F – Fixed point

Connection type

A – Threaded joint outside (standard)

I – Threaded joint inside

H – Threaded joint, rotated through 90° to the outside

K – Threaded joint, rotated through 90° to the inside

In the standard version, the connectors are mounted with the threaded joint outwards (**FA/MA**).

When ordering please specify the desired connection type (see ordering key on page 419).

The connection type can subsequently be altered simply by varying the connectors.

Guide channels

➤ from page 375



Strain relief devices

➤ from page 381



Cables for cable carrier systems

➤ from page 438



Inside heights

19
87

Inside widths

25
800

kabelschlepp.de

Fon:

+49 2762 4003-0

OnlineEngineer.de
TSUBAKI KABELSCHLEPP
Cable Carrier Configurator

Types MC 0320, 0650, 0950, 1250, 1300

UMB (Universal Mounting Brackets) made of aluminum – Type MC 0650

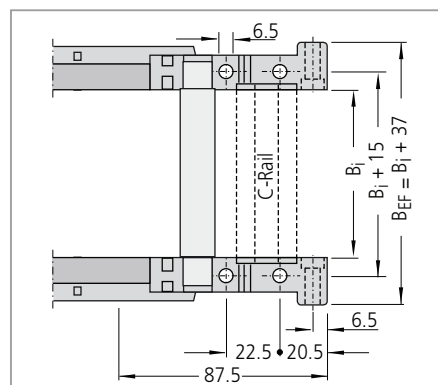
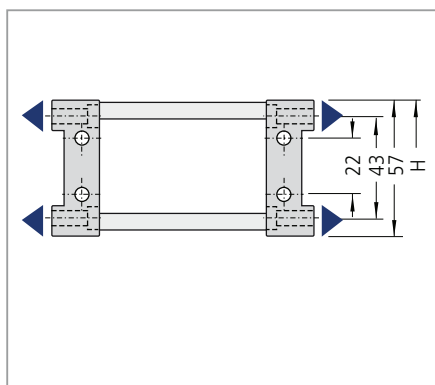
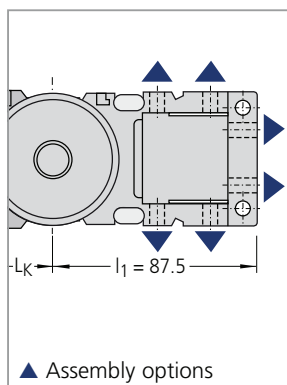

The dimensions of the fixed point and driver connections are identical.
End connectors made of steel plate available on request.

Optional C-rails and strain relief elements for cables can be found on the following pages.

When ordering please specify the connection type FU/MU (see ordering key on page 419).

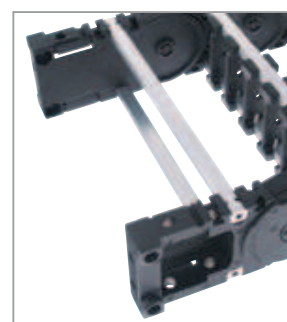

UMB (Universal Mounting Brackets) made of aluminum – Types MC 0950 and 1250 UMB (Universal Mounting Brackets) made of plastic – Type MC 1300

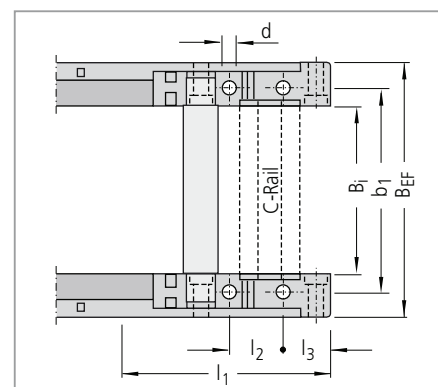
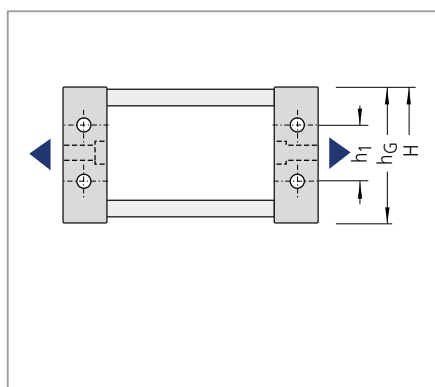
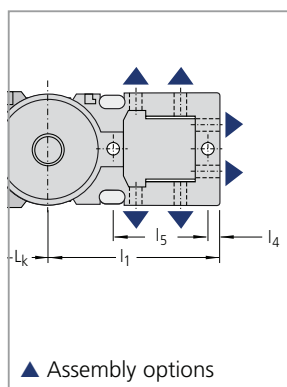

The dimensions of the fixed point and driver connections are identical.
End connectors made of steel plate available on request.

Optional C-rails and strain relief elements for cables can be found on the following pages.

When ordering please specify the connection type FU/MU (see ordering key on page 419).



Type	B _{EF}	b ₁	d	l ₁	l ₂	l ₃	l ₄	l ₅	h ₁	h _G
MC 0950	B _i + 44	B _i + 24.5	8.5	136	35	24.5	8.5	80	45	80
MC 1250	B _i + 51	B _i + 28	11	168	35	31	10.5	94.5	45	96
MC 1300	B _i + 50	B _i + 29	11	158	35	20	–	–	66	120

B_{EF} = Width of the cable carrier over connector

Dimensions in mm

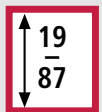
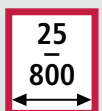
Inside
heightsInside
widths

kabelschlepp.de

Fon:

+49 2762 4003-0

Use our free
project planning service.

Types MC 0320, 0650, 0950, 1250, 1300

Strain relief devices

Both-sided strain relief combs made of plastic (MC 0650)

The cables can be fixed securely and simply using the **optional strain relief combs**.

The strain relief combs are installed between the UMBs, and do not need to be bolted on separately or mounted on a C-Rail.

Please state on the order whether strain relief combs are needed.

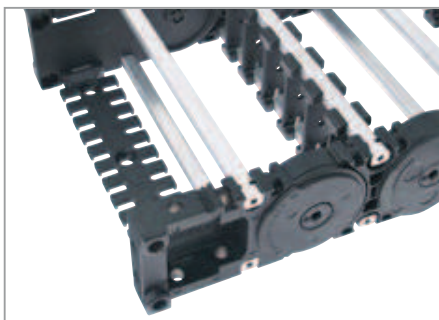

■ Universal mounting bracket
with strain relief comb

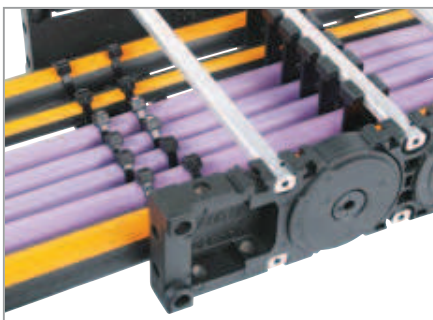

■ Both-sided strain relief comb



■ Fixing in the UMB.

Type	B _i mm	n _z
MC 0650	75	5
MC 0650	95	7
MC 0650	100	7
MC 0650	115	8
MC 0650	120	9
MC 0650	125	9
MC 0650	145	11
MC 0650	150	11
MC 0650	170	13
MC 0650	175	13
MC 0650	195	15
MC 0650	200	15
MC 0650	225*	17
MC 0650	250*	19

n_z = Number of teeth on one
side of the comb

* on request

Inside heights

19
-
87

Inside widths

25
-
800

kabelschlepp.de

Fon:

+49 2762 4003-0

OnlineEngineer.de
TSUBAKI KABELSCHLEPP
Cable Carrier Configurator

Types MC 0320, 0650, 0950, 1250, 1300

Strain relief devices

C-rails for LineFix bracket clamps, SZL strain reliefs and clamps

The optional C-rails are fixed by means of the universal mounting brackets and do not have to be screwed separately.

Please state in your order whether C-rails are needed.



■ Universal mounting bracket with C-rail

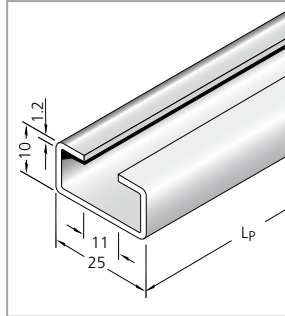

■ **MC 0650:**
Integratable C-rail
25 x 10 mm,
slit width 11 mm,
material steel,
Item-No. 3931

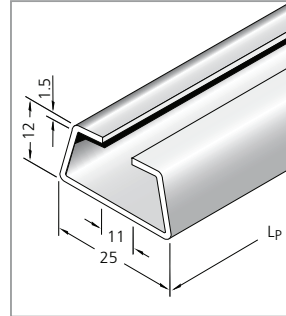

■ **MC 1300:**
Integratable C-rail
25 x 12 mm,
slit width 11 mm,
material steel,
Item-No. 3934

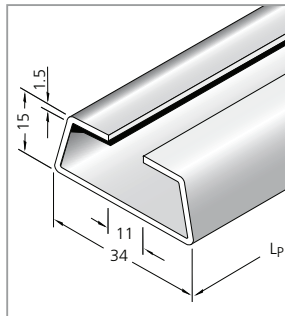

■ **MC 0950, 1250 and 1300:**
Integratable C-rail
34 x 15 mm,
slit width 11 mm,
material steel,
Item-No. 3935

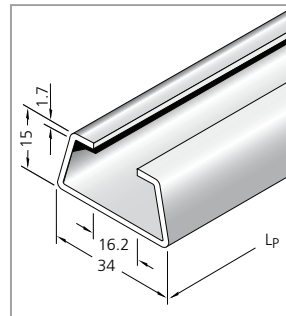

■ **MC 0950, 1250 and 1300:**
Integratable C-rail
34 x 15 mm,
slit width 16 – 17 mm,
material aluminum,
Item-No. 3926,
material steel,
Item-No. 3932

Our LineFix strain reliefs are optimally suited for the C-rails. (LineFix bracket clamps and other strain relief devices – see Accessories chapter, from page 381 onwards).

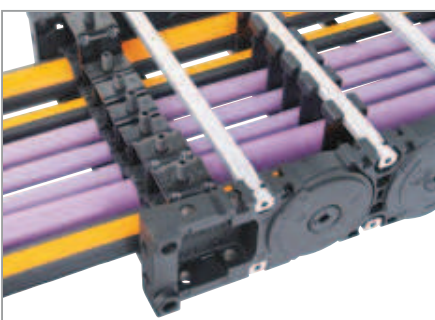

■ C-rail with LineFix strain relief

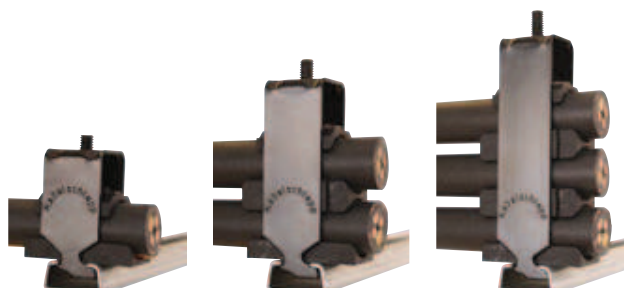

Inside
heights19
72Inside
widths24
557

kabelschlepp.de

Fon:

+49 2762 4003-0

Use our free
project planning service.

Type ME/MK

with plastic stays

- ME 0320
available in 4 mm width sections
- MK 0475, ME/MK 0650
available in 8 mm width sections
- ME/MK 0950/1250
available in 16 mm
width sections



Types ME 0320, 0650, 0950 and 1250

(Stay variant RE, unscrewable stays)

Opening options

Outside/Inside: simply by turning

Stay arrangement

ME 0320

Stays mounted on every chain link.

ME 0650, 0950 and 1250

Standard: on every 2nd chain link

Stays can be fitted on every chain link,
please specify when placing your order.



Types MK 0475, 0650, 0950 and 1250

(Stay variant RD, opening stays)

Opening options

MK 0475

Opening variant 02 (Standard):

Outside: simply by levering open
(right or left)

Inside: simply by turning

Opening variant 01:

Outside: simply by turning

Inside: simply by levering open
(right or left). If you require opening
variant 01, please state when placing
your order.

MK 0650, 0950 and 1250

Outside: simply by levering open
(right or left)

Inside: simply by turning



Stay arrangement

MK 0475

Stays mounted on every chain link.

MK 0650, 0950 and 1250

Standard: on every 2nd chain link

Stays can be fitted on every chain link,
please specify when placing your order.

Types ME 0320, MK 0475, ME/MK 0650, 0950, 1250

Dimensions and intrinsic chain weight

Type	Stay variant	h_i	h_g	B_i min	q_k min	B_i max	q_k max	B_k	Width sections
ME 0320	RE	19	27.5	25	0.46	149	0.85	$B_i + 11$	4
MK 0475	RD	28	39	24	0.79	280	3.03	$B_i + 17$	8
ME 0650	RE	42	57	50	2.00	266	2.84	$B_i + 34$	8
MK 0650	RD	42	57	50	2.00	258	2.81	$B_i + 34$	8
ME/MK 0950	RE/RD	58	80	45	3.00	557	6.20	$B_i + 39$	16
ME/MK 1250	RE/RD	72	96	71	4.30	551	5.80	$B_i + 45$	16

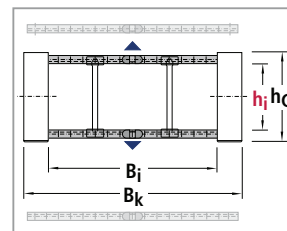

Dimensions in mm/Weights in kg/m

Inside heights

19
72

Inside widths

24
557

Bend radius and pitch

Type	Bend radii KR mm									
ME 0320	37	47	77	100	200	—	—	—	—	—
MK 0475	55	75	100	130	160	200	250	300	—	—
ME/MK 0650	75	95	115	145	175	220	260	275	300	350
ME/MK 0950	140	170	200	260	290	320	380	—	—	—
ME/MK 1250	180	220	260	300	340	380	500	—	—	—

Pitch:

ME 0320: $t = 32$ mm
 MK 0475: $t = 47.5$ mm
 ME/MK 0650: $t = 65$ mm
 ME/MK 0950: $t = 95$ mm
 ME/MK 1250: $t = 125$ mm

Load diagram

for unsupported length L_f depending on the additional load

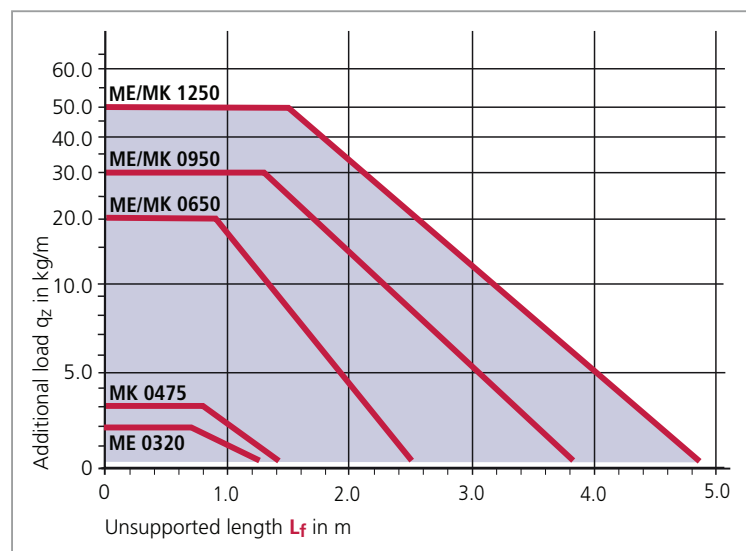

Unsupported length L_f

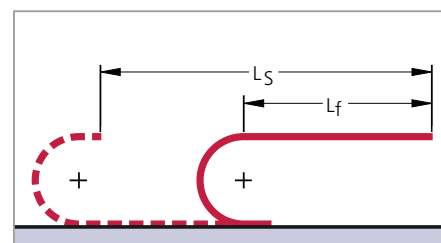

In the case of longer travel lengths, sag of the cable carriers is technically permissible depending on the application.

In a gliding arrangement, even longer travel lengths are possible (see page 375).

We are at your service to advise on these applications.

Example of ordering

Cable carrier					Divider system		Connection
ME 1250	407	RE	340	2875	TS 0	5	FU/MU
Type	Inside width B_i in mm	Stay variant	Bend radius KR in mm	Chain length L_k in mm (without connection)	Divider system	Number of dividers n_T	Connection Fixed point/Driver

Ordering divider systems:

Please state the designation of the divider system (TS 0, TS 1 ...) and the number of dividers. Possibly attach a sketch with the dimensions.

kabelschlepp.de

Fon: +49 2762 4003-0

OnlineEngineer.de
 TSUBAKI KABELSCHLEPP
 Cable Carrier Configurator

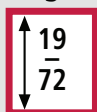
Inside
heightsInside
widths

kabelschlepp.de

Fon:

+49 2762 4003-0

Use our free
project planning service.

Types ME 0320, MK 0475, ME/MK 0650, 0950, 1250

Fixing the dividers

In the standard version, dividers or the complete divider system (dividers with height separation) can be moved in the cross section.
(Mounting version A)

However, it is often also possible to fix dividers or complete divider systems (dividers with height separation) by turning the stays.
(Mounting version B).

If the fixed mounting version is desired, please state this when placing your order.

Types ME 0320

Mounting version A (standard)

Movable divider:

Divider without arresting cams

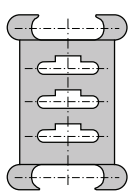

Caution: With type ME 0320, the stay does not have a groove. Different dividers are required for mounting versions A and B:

Version A: Dividers **without** arresting cams

Version B: Dividers **with** arresting cams

Mounting version B

Fixed divider:

Divider with arresting cams

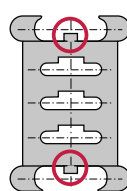

Thus, with type ME 0320, the mounting version A **cannot** be changed into mounting version B simply by turning the stay.

Types MK 0475, ME/MK 0650, 0950 and 1250

Mounting version A (standard)

Movable divider:

The arresting cam of the divider can move in the groove of the stay.

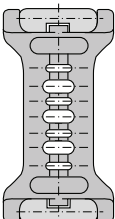

With a movable assembly of the dividers (mounting version A), the holes in the stay do not have any function and hence the dimension a_x -section is meaningless.

Mounting version B

Fixed divider:

The arresting cam of the divider is fixed in the borehole of the stay.

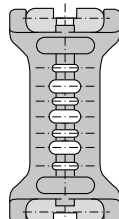

Please note that the dividers can only be fixed in positions at which there is a hole in the stay. The dimension a_x -section specifies the hole intervals in the stay.

Hole intervals = fixing positions of the dividers (a_x -sections)

By simply turning the stays, it is also possible at any subsequent time to switch between movable and fixed assembly of the dividers (not in case of ME 0320).

Types ME 0320, MK 0475, ME/MK 0650, 0950, 1250

Divider system TS 0

Type	Stay variant	h_i mm	Mounting version A			Mounting version B			
			S_T mm	a_T min mm	a_x min mm	S_T mm	a_T min mm	a_x min mm	a_x section mm
ME 0320	RE	19	2	3	6	2	4.5	8	4
MK 0475	RD	28	2.8	6	7.8	2.8	12	8	8
ME/MK 0650	RE/RD	42	4.2	6.5	13	4.2	13	16	8
ME/MK 0950	RE/RD	58	6	7.5	14.5	6	22.5	16	16
ME/MK 1250	RE/RD	72	8	5	14.5	8	19.5	16	16

In the standard version, the divider systems are mounted on every second chain link.

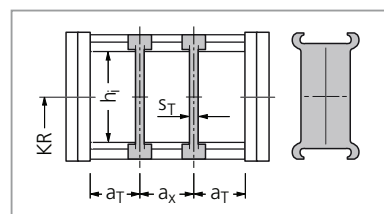

Inside heights

19
72

Inside widths

24
557

Divider system TS 1 with continuous height subdivision made of aluminum

Type	Stay variant	h_i mm	Mounting version A			Mounting version B				S_H mm	h_1 mm	h_2 mm
			S_T mm	a_T min mm	a_x min mm	S_T mm	a_T min mm	a_x min mm	a_x section mm			
ME 0320	RE	19	2	3	6	2	4.5	8	4	2	10	—
MK 0475	RD	28	2.8	6	7.8	2.8	12	8	8	2.4	15	—
ME/MK 0650	RE/RD	42	4.2	6.5	13	—	—	—	—	4	10	22
ME/MK 0950	RE/RD	58	6	7.25	14.5	6	22.5	16	16	4	22	—
ME/MK 1250	RE/RD	72	8	5	14.5	8	19.5	16	16	4	32	—

In the standard version, the divider systems are mounted on every second chain link.

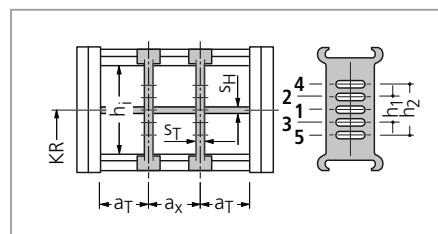

Divider system TS 3

ME/MK 0650, 0950 and 1250 with section subdivision, partitions made of plastic

The dividers for divider system TS 3 do not have any arresting cams. Thus, no mounting version B (fixed mounting) is possible.

Type	Stay variant	h_i mm	S_T mm	a_T min mm	a_x min mm	S_H mm	h_1 mm	h_2 mm	h_3 mm	h_4 mm
ME 0650	RE/RD	42	8	4	16*	4	14	28	—	—
ME 0950	RE/RD	58	8	4	16*	4	14	28	42	—
ME 1250	RE/RD	72	8	4	16*	4	14	28	42	56

* When using plastic partitions

The dividers are fixed by the partitions, the complete divider system is movable.

In the standard version, the divider systems are mounted on every second chain link.

Divider system TS 2 with fixable dividers (mounting version B) and aluminum height subdivisions in 1 mm width sections is available. Please do get in touch with us.

Dimensions of the plastic partitions for divider system TS 3, see next page.

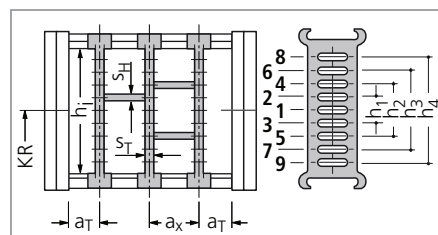

kabelschlepp.de

Fon: +49 2762 4003-0

OnlineEngineer.de
TSUBAKI KABELSCHLEPP
Cable Carrier Configurator

Types ME 0320, MK 0475, ME/MK 0650, 0950, 1250

Dimensions of the plastic partitions for TS 3

Inside heights

19
72

Inside widths

24
557

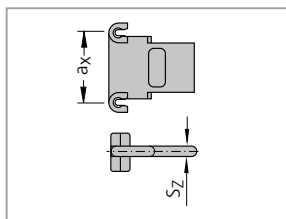

Aluminum partitions in 1 mm width sections are also available.

S _z	a _x (center-to-center dividers)									
4	16	18	23	28	32	33	38	43	48	58
	64	68	78	80	88	96	112	128	144	160
	176	192	208	–	–	–	–	–	–	–

Dimensions in mm

When using **partitions with a_x > 112 mm** there should be an additional central support with a **twin divider**.

Thickness of the twin dividers: ME/MK 0650 S_T = 3 mm, ME/MK 0950, 1250 S_T = 4 mm

Twin dividers are designed for subsequent fitting in the partition system.

Gliding elements – the economical solution for gliding applications

Replaceable glide shoes made of plastic*

To extend the life of cable carriers in gliding operations KABELSCHLEPP supplies detachable, exchangeable glide shoes.

Replaceable glide shoes are a very economical solution. When wear occurs only the glide shoes are replaced, and not the complete cable carrier. For travel speeds > 2.5 m/s and large additional loads, a highly wear-resistant special material is used.

For types ME/MK 0950 and 1250 **OFFROAD glide shoes** with 80 % greater wear volumes are also available. We recommend their use in extreme environmental conditions (with particularly abrasive materials such as e.g. sand, dust, corundum).



* Not for ME 0320

Chain height with glide shoes:

MK 0475: $h_G' = h_G + 2.5 = 41.5$
ME/MK 0650: $h_G' = h_G + 3.2 = 60.2$
ME/MK 0950: $h_G' = h_G + 3.5 = 83.5$
ME/MK 1250: $h_G' = h_G + 3.5 = 99.5$

Dimensions in mm

Minimum bend radii when using glide shoes:

MK 0475:
 KR_{min} = 100 mm
ME/MK 0650:
 KR_{min} = 95 mm
ME/MK 0950:
 KR_{min} = 140 mm
ME/MK 1250:
 KR_{min} = 180 mm

! By means of a positive snap connection, the glide shoes sit firmly on the chain link.

Minimized hinge wear owing to the "life extending 2 disc principle"

In the M Series*, the push and pull forces are transmitted via the optimum link design for this purpose.

As a result link wear is reduced to a minimum and the life of the cable carrier is considerably lengthened.

* not for type 0320

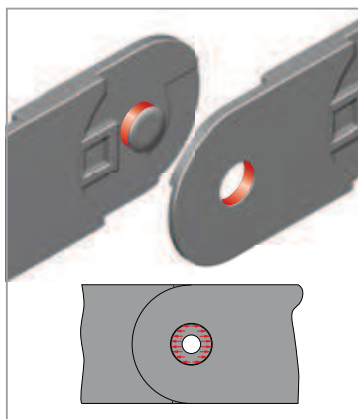

■ Force transmission with a pin-hole joint

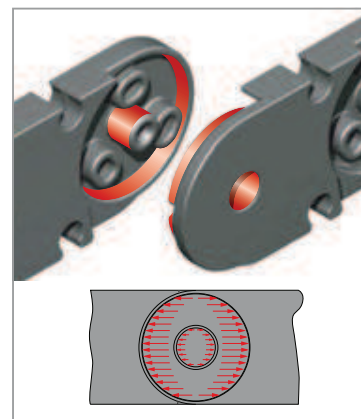

■ Force transmission with the "life extending 2 disc principle"

Subject to change.

Inside heights

19
72

Inside widths

24
557

kabelschlepp.de

Fon:

+49 2762 4003-0

OnlineEngineer.de
TSUBAKI KABELSCHLEPP
Cable Carrier Configurator

Types ME 0320, MK 0475, ME/MK 0650, 0950, 1250

Connectors made of plastic/aluminum – Type ME 0320

Standard connectors without strain relief.

Connectors with strain relief available on request.

Fixed point connection

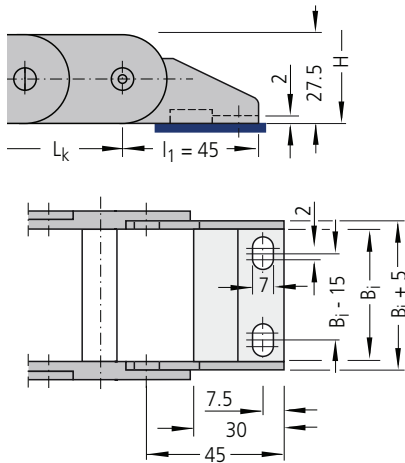

Driver connection

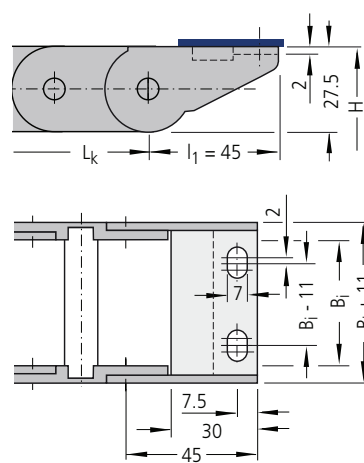

Connection variants – Type ME 0320

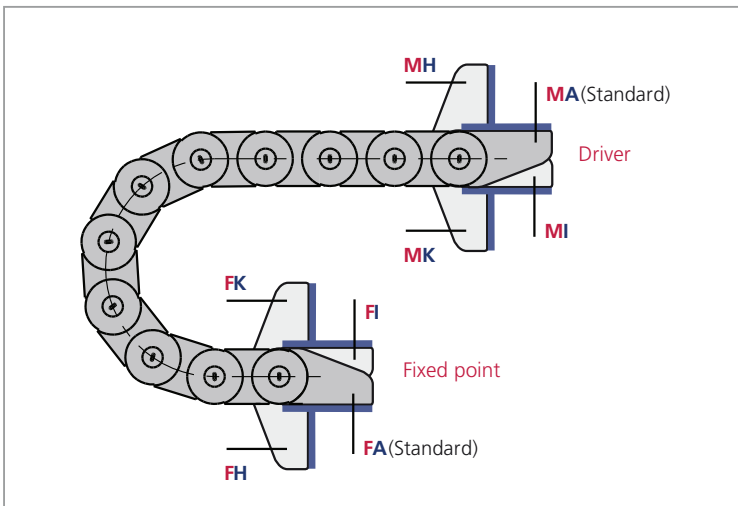

Connection point

- M** – Driver
- F** – Fixed point

Connection type

- A** – Threaded joint outside (standard)
- I** – Threaded joint inside
- H** – Threaded joint, rotated through 90° to the outside
- K** – Threaded joint, rotated through 90° to the inside

In the standard version, the connectors are mounted with the threaded joint outwards (**FA/MA**).

When ordering please specify the desired connection type (see ordering key on page 419).

The connection type can subsequently be altered simply by varying the connectors.

Guide channels
➤ from page 375

Strain relief devices
➤ from page 381

Cables for cable carrier systems
➤ from page 438



Inside
heights19
72Inside
widths24
557

kabelschlepp.de

Fon:

+49 2762 4003-0

Use our free
project planning service.

Types ME 0320, MK 0475, ME/MK 0650, 0950, 1250

Connectors made of plastic/steel – Type MK 0475

End connector made of steel plate.

Screwable strain relief made of aluminum on request.

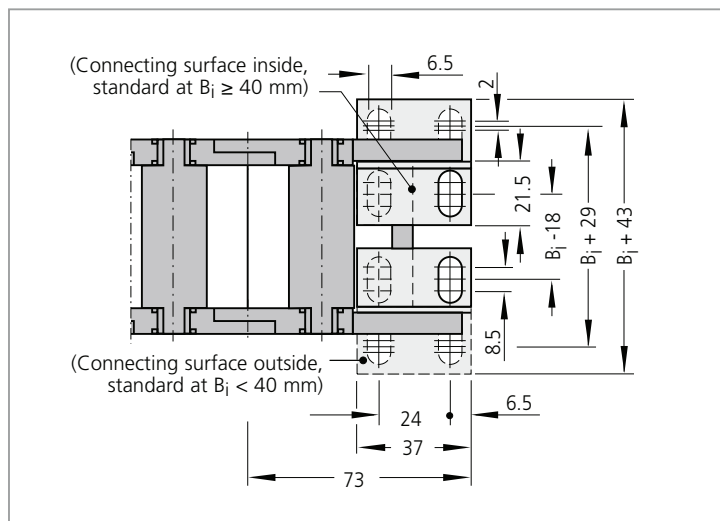
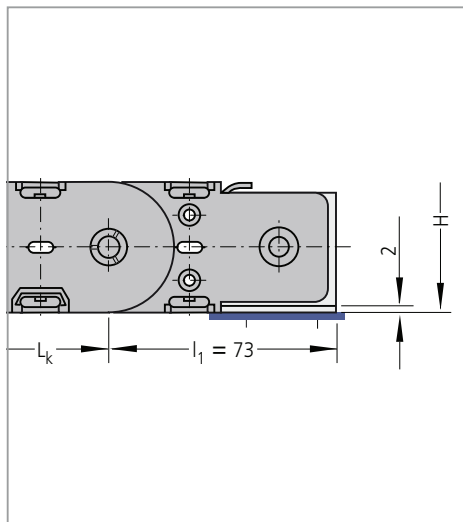

The dimensions of the fixed point and driver connections are identical.

Connection variants – Type MK 0475

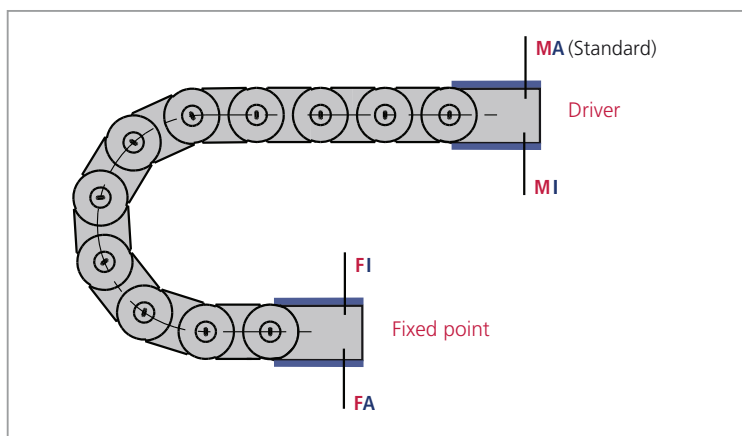

Connection point

- M** – Driver
- F** – Fixed point

Connection type

- A** – Threaded joint outside (standard)
- I** – Threaded joint inside

In the standard version, the connectors are mounted with the threaded joint outwards (**FA/MA**).

When ordering please specify the desired connection type (see ordering key on page 419).

The connection type can subsequently be altered simply by varying the connectors.

Inside heights

19
72

Inside widths

24
557

kabelschlepp.de

Fon:

+49 2762 4003-0

OnlineEngineer.de
TSUBAKI KABELSCHLEPP
Cable Carrier Configurator

Types ME 0320, MK 0475, ME/MK 0650, 0950, 1250

UMB (Universal Mounting Brackets) made of aluminum – Type ME/MK 0650

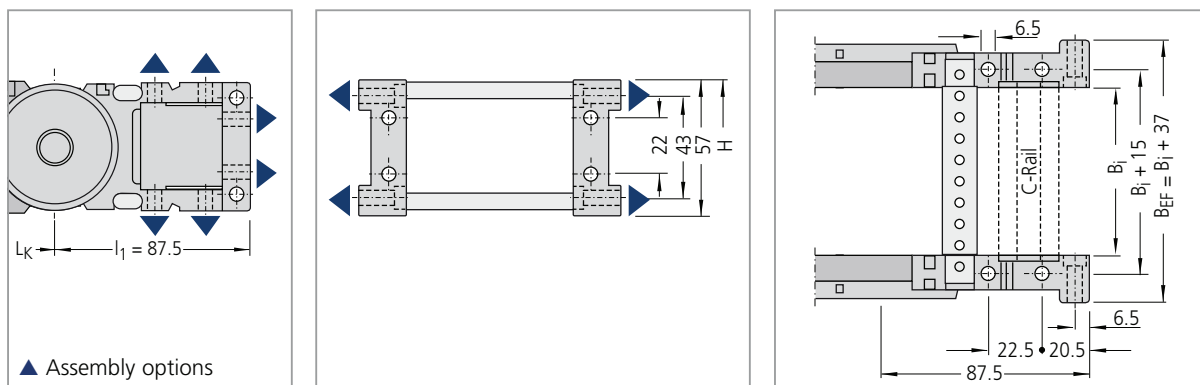

The dimensions of the fixed point and driver connections are identical.
End connectors made of steel plate available on request.

Optional C-rails and strain relief elements for cables can be found on the following pages.

When ordering please specify the connection type FU/MU (see ordering key on page 419).

UMB (Universal Mounting Brackets) made of aluminum – Types ME/MK 0950 and 1250

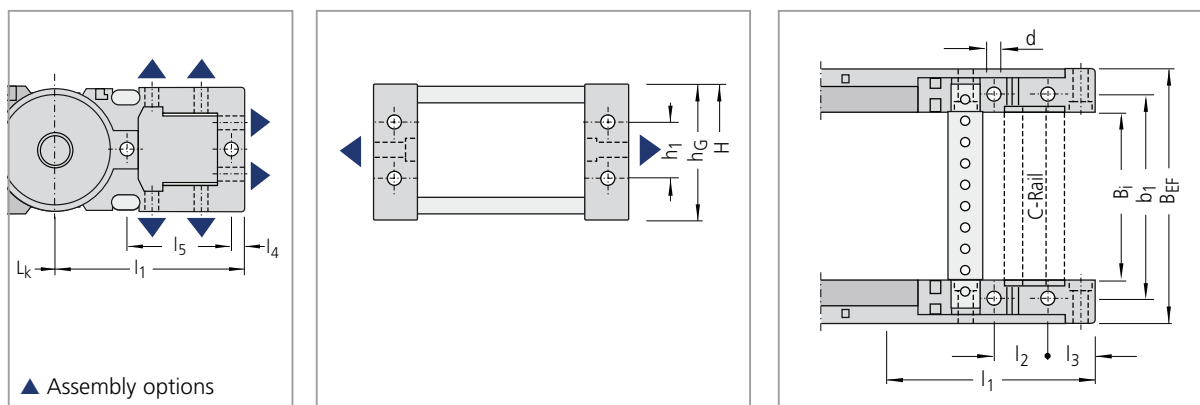

The dimensions of the fixed point and driver connections are identical.
End connectors made of steel plate available on request.

Optional C-rails and strain relief elements for cables can be found on the following pages.

When ordering please specify the connection type FU/MU (see ordering key on page 419).

Type	B _{EF}	b ₁	d	l ₁	l ₂	l ₃	l ₄	l ₅	h ₁	h _G
ME/MK 0950	B _i + 44	B _i + 24.5	8.5	136	35	24.5	8.5	80	45	80
ME/MK 1250	B _i + 51	B _i + 28	11	168	35	31	10.5	94.5	45	96

B_{EF} = Chain width over connector

Dimensions in mm

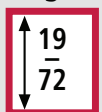
Inside
heightsInside
widths

kabelschlepp.de

Fon:

+49 2762 4003-0

Use our free
project planning service.

Types ME 0320, MK 0475, ME/MK 0650, 0950, 1250

Strain relief devices

C-rails for LineFix bracket clamps, SZL strain reliefs and clamps

The optional C-rails are fixed by means of the universal mounting brackets and do not have to be screwed separately.

Please state in your order whether C-rails are needed.

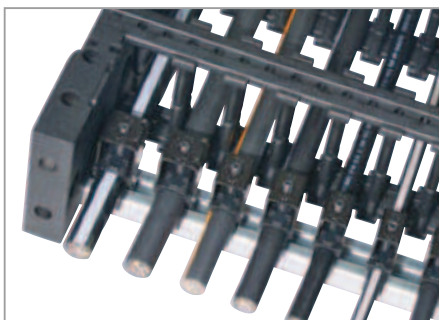

■ Universal mounting bracket with C-rail

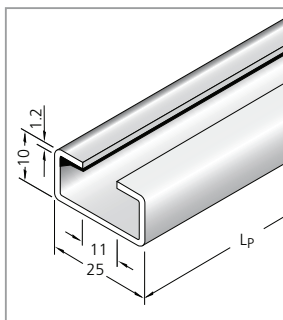

■ **ME/MK 0650:**
Integratable C-rail
25 x 10 mm,
slit width 11 mm,
material steel,
Item-No. 3931

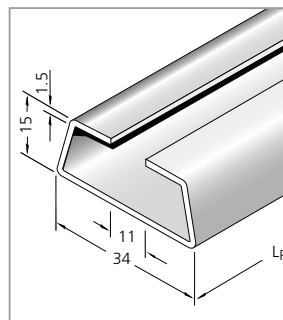

■ **ME/MK 0950 and 1250:**
Integratable C-rail
34 x 15 mm,
slit width 11 mm,
material steel,
Item-No. 3935

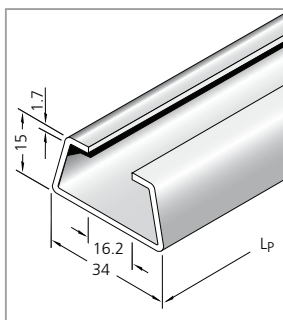

■ **ME/MK 0950 and 1250:**
Integratable C-rail
34 x 15 mm,
slit width 16 – 17 mm,
material aluminum,
Item-No. 3926,
material steel,
Item-No. 3932

Our LineFix strain reliefs are optimally suited for the C-rails. (LineFix bracket clamps and other strain relief devices – see Accessories chapter, from page 381 onwards).



■ C-rail with LineFix strain relief

